

## WM LIGHT

The WM LIGHT, made of aluminium, is extremely lightweight due to its spring-assisted system. Equipped with a quick connect and release system, the WM Light is easy to transfer from one vehicle to another once the simple location plates are installed. The ramp can be opened directly onto the ground without the use of feet and is available with an anti-slip aluminium surface or with mesh version.



DOCK LOADING PIN



QUICK CONNECTION SYSTEM



EQUIPPED WITH 2 MOBILE PLATES



EQUIPPED WITH WHEELS

### DIMENSIONS & LOAD CAPACITY



### USES

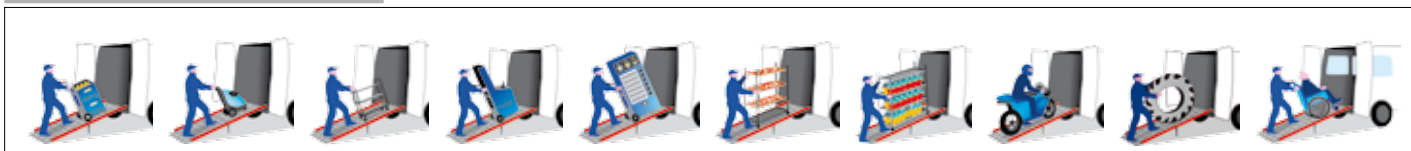

## WM LIGHT TECHNICAL DATA

POWER REQUIRED: approx 10 Kg

SPACE REQUIRED: approx 21 cm

WARRANTY: 2 years

Model	A (cm)	H (mm)	L (mm)	L1 (mm)	L2 (mm)	P (mm)	P1 (mm)	Weight A* (Kg)
WM LIGHT 80	1750	960	1100	800	1160	215	345	44
WM LIGHT 80	2000	1085	1100	800	1160	215	345	48
WM LIGHT 80	2250	1210	1100	800	1160	215	345	52
WM LIGHT 80	2500	1335	1100	800	1160	215	345	56
WM LIGHT 80	2750	1460	1100	800	1160	215	345	60
WM LIGHT 80	3000	1585	1100	800	1160	215	345	64
WM LIGHT 80	3250	1705	1100	800	1160	215	345	68
WM LIGHT 100	1750	960	1300	800	1360	215	345	46
WM LIGHT 100	2000	1085	1300	1000	1360	215	345	50,5
WM LIGHT 100	2250	1210	1300	1000	1360	215	345	55
WM LIGHT 100	2500	1335	1300	1000	1360	215	345	60
WM LIGHT 100	2750	1460	1300	1000	1360	215	345	64,5
WM LIGHT 100	3000	1585	1300	1000	1360	215	345	69
WM LIGHT 100	3250	1705	1300	1000	1360	215	345	73,5

\* The weight indicated does not include the fitting kit. The standard fitting kit weights 5 kg.

\* The weight indicated does not include the swivel kit. The optional swivel kit, weights 6.7 Kg.

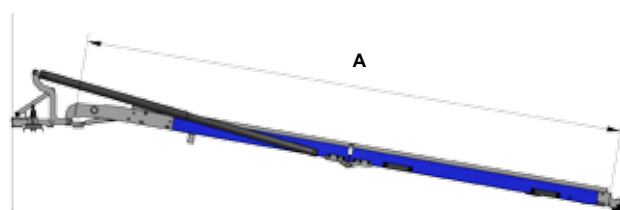
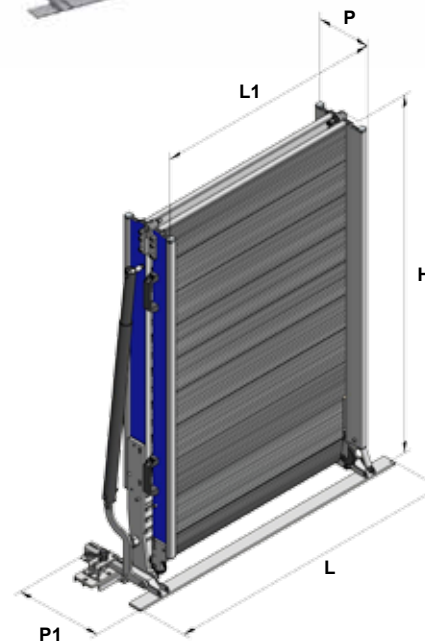

WM LIGHT



WM LIGHT-R



**MAXIMUM LOAD CAPACITY**  
400 Kg



**MAXIMUM LOAD CAPACITY**  
300 Kg

## EXTENSION KIT

Extension kit of Light Serie fitted directly on the ramp

KIT for:	L1 (cm)	B (mm)	C (mm)	A (mm)	H (mm)	P (mm)	P2 (mm)	Weight (Kg)
WM LIGHT 80	800	1750	830	2580	960	215	245	24
WM LIGHT 80	800	2000	955	2955	1085	215	245	25
WM LIGHT 80	800	2250	1080	3330	1210	215	245	26
WM LIGHT 80	800	2500	1205	3705	1335	215	245	27
WM LIGHT 100	1000	1750	830	2580	960	215	245	25
WM LIGHT 100	1000	2000	955	2955	1085	215	245	26
WM LIGHT 100	1000	2250	1080	3330	1210	215	245	27
WM LIGHT 100	1000	2500	1205	3705	1335	215	245	28

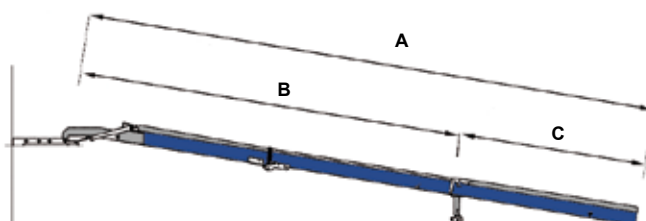
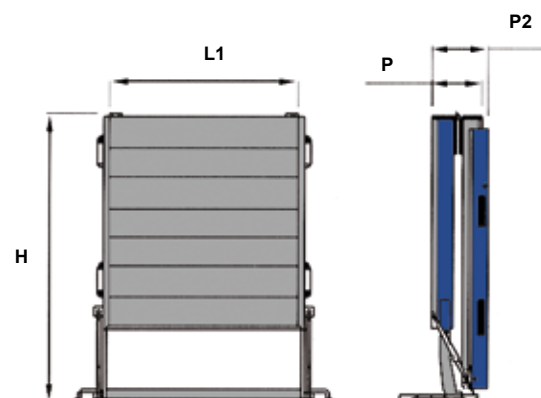

## WM LIGHT VERSIONS

### STANDARD:

WM Light detachable and free standing. A procedure that can be performed within a couple of minutes.

### OPTIONAL:

WM Light with external rotation kit.

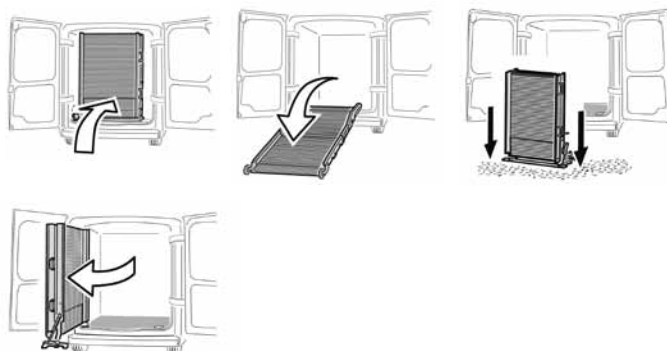

www.wmsystem.com

## VERSIONS OF FLAP

The ramp is equipped with a flap on the bottom, that comes with a round edge as standard for dock loading. There are also two straight flap options to allow a smoother lip for smaller wheels on to the ground. These need to be specified on the order.

### ROUND AND FLEXIBLE FLAP

STANDARD

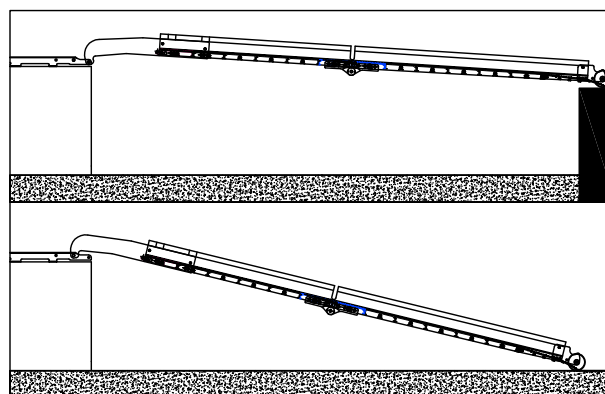
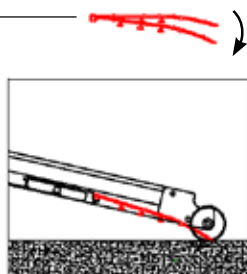

### STRAIGHT AND FIXED FLAP

OPTIONAL 7AL100

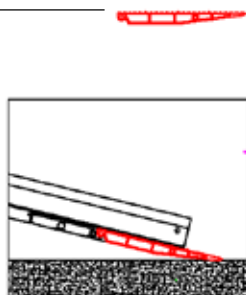

### STRAIGHT AND FLEXIBLE FLAP

OPTIONAL 7AL101

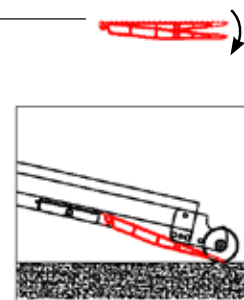

## VERSIONS OF PLATFORM



A - Anti-slip aluminium

The material of the floor is anti-slip anodised aluminium, standard on the WM LIGHT. The maximum load capacity is 400 kg.



R - Aluminium expanded mesh

As an alternative you can have an aluminium expanded mesh surface, in the WM LIGHT-R version. The maximum load capacity is 300 kg and the widths available are 80 and 100 cm.

## EXTENSION KIT



The extension kit is fitted directly on to the ramp, allowing the length of loading ramp to be extended, decreasing the slope.